

ARC-TIS-20MM-SIL

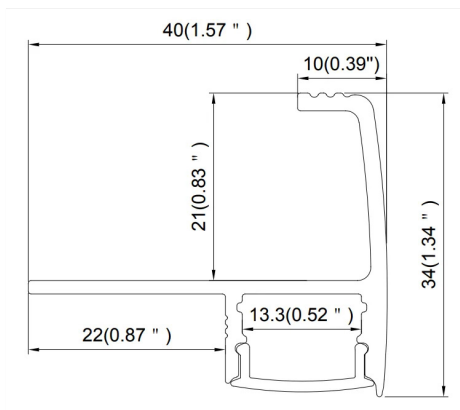

Profile Type	LED TAPE WIDTH
Tile In	up to 12mm Tape
COLOUR VERSIONS	LENGTH
Silver	2000 mm

TECHNICAL DRAWING WITH DIMENSIONS



TECHNICAL INSTRUCTIONS

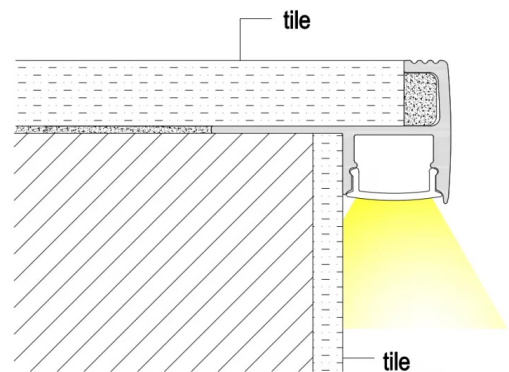

PRODUCT OVERVIEW

The ARC-LED 2m 20 mm Tile-In Stair Profile is a premium aluminium LED profile designed to integrate wider LED strip lighting neatly into stair risers and step edges. With a generous 20 mm internal channel, this profile accommodates a broader range of LED strip sizes, delivering bold, even illumination while maintaining a sleek and architectural appearance.

Crafted from high-quality aluminium with a refined black anodised finish, this tile-in stair profile combines durability with modern aesthetics. Its tile-in configuration allows the profile to sit flush with the stair surface, providing a discreet and integrated lighting solution that enhances both style and safety — perfect for contemporary residential, commercial, and hospitality stair applications.

TECHNICAL SPECIFICATIONS

Length	2000mm
Internal Width	13.3mm
Overall Width	40mm
Depth	34mm
Material	Extruded Aluminum 6063-T5
Led Lights	Fits upto 12mm Tape

ACCESSORIES



DIFFUSERS

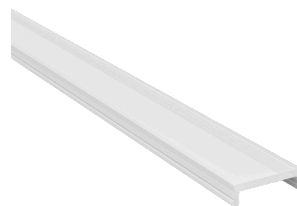

OPAL DIFFUSER INCLUDED