

PRODUCT DATA SHEET

COB & CSP SERIES

COB 840LEDs/m 18W/m



ARC-RS-RGBW-COB-12MM



PRODUCT DATA SHEET

Product Features

1. Beautiful linear effect with big beam angle 180°.
2. Adopt brand LED chip, achieving good quality and high brightness.
3. Our COB led strip is certified by CE & ROHS & UL & UKCA.
4. Easy to install and preserve.
5. RGBW color, ideal for office, residential, retail and industry lighting.
6. Warranty: 3 years.

CCT Option



Lighting Effect



Lighting Effect

PRODUCT DATA SHEET

IP Rating Option

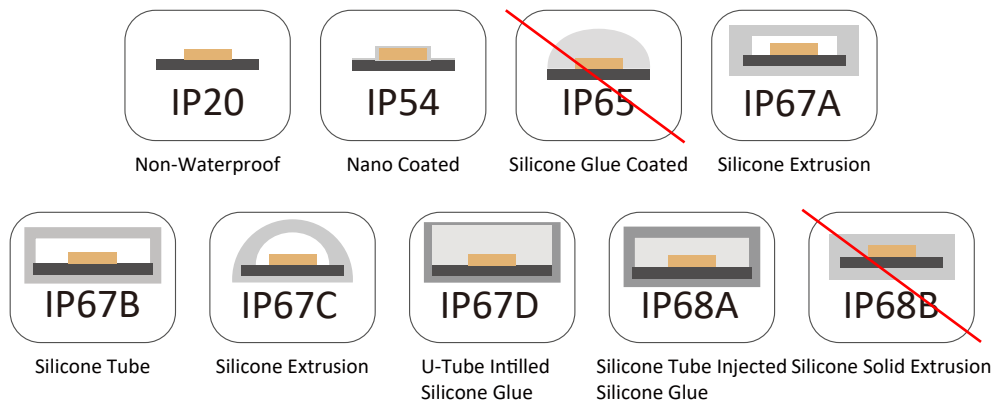

Dimension(mm/inch)



Length/Reel	Width	Height	LED Spacing	Min. Cutting
5000mm/197in	12mm/0.472in	3mm/0.118in	/	Every 33.33mm/1.312in (28LEDs)

Note:

Led strip length tolerance is $\pm 10\text{MM}$ based on 5M/roll, IP20 & IP54.

PRODUCT DATA SHEET

Data

Part Number	Working Voltage	Power	Current	LED Qty	CRI
ARC-RS-RGBW-COB-12MM	24VDC	18W/m	0.7486A/m	840LED/m	90+
		5.48W/ft	0.228A/ft	≈256LEDs/ft	

CCT (°K)	Luminous Efficiency	Lumen	Maximum Length
RGBW(2700K)	53lm/W	951lm/m(290lm/ft)	5M(16.4ft)
RGBW(3000K)	53lm/W	951lm/m(290lm/ft)	5M(16.4ft)
RGBW(4000K)	56lm/W	1012lm/m(308lm/ft)	5M(16.4ft)
RGBW(6500K)	56lm/W	1012lm/m(308lm/ft)	5M(16.4ft)

Note:

The data base on IP20.

The Lumen output value tolerance is ±5% due to testing way.

The CCT tolerance is ±5% due to testing way.

Absolute Maximum Ratings

Parameter	Symbol	Value
Thermal Measurement Point	Tc	80°C/176°F
Operating Temperature	Topr	<80°C/<176°F
Storage Temperature	Ts	-20~+ 60°C/-68~140°F
Number of FPC Connection		

PRODUCT DATA SHEET

Wiring Diagram Application

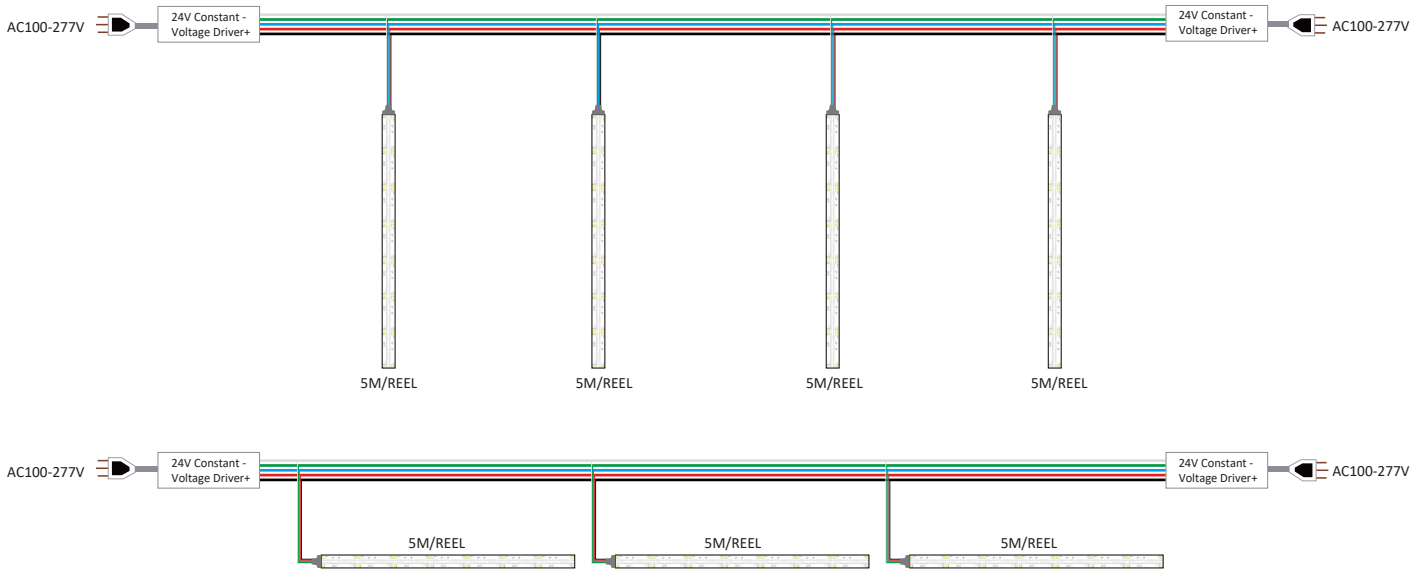

Packaging

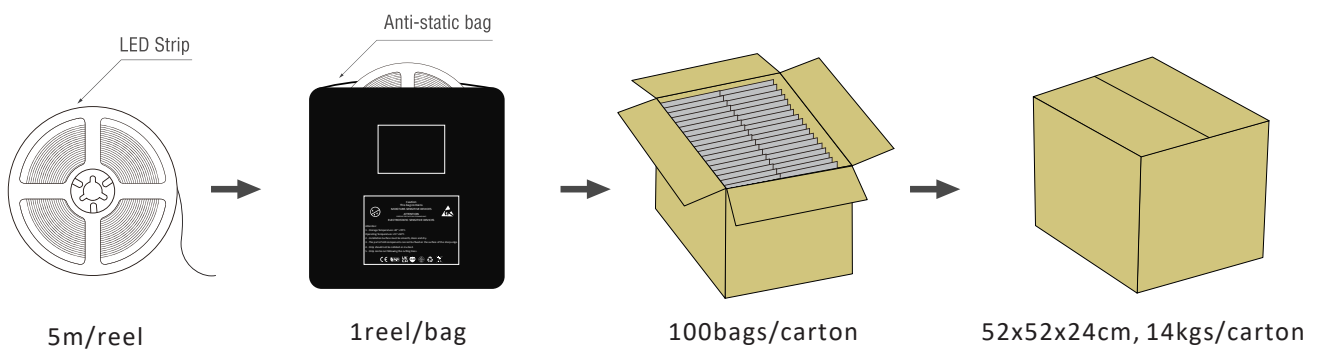

PRODUCT DATA SHEET

Cautions

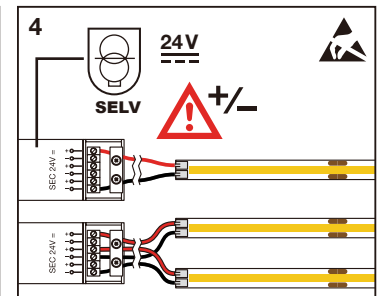
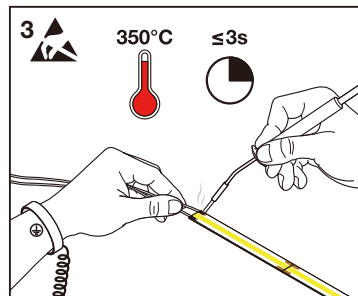
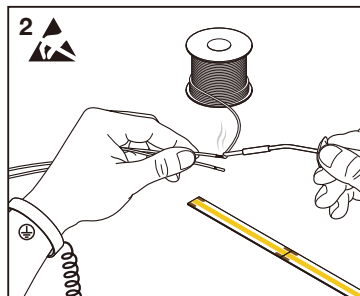
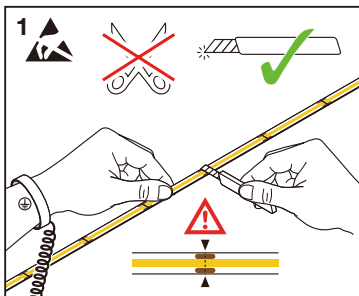
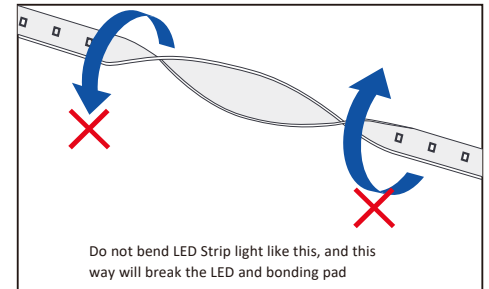
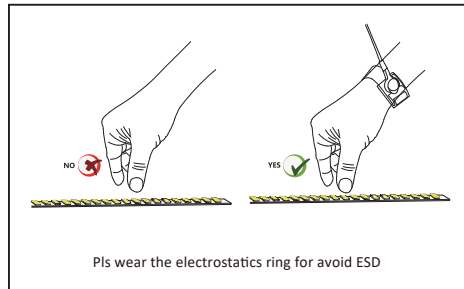
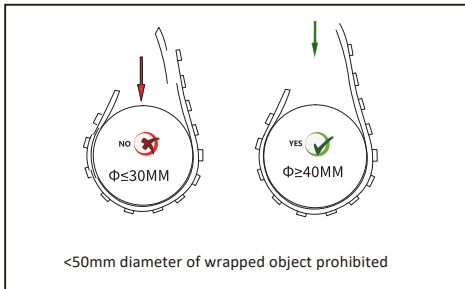

Safety & Disclosures

1. Do not install the led strip in environment where excessive heat may occur.
2. Only use copper wiring. Use wires rated for at least $176^{\circ}\text{F}(80^{\circ}\text{C})$ and certified for use with
3. Do not install IP20 LED strip products in outdoor / wet location environments.
4. Excessive handling, bending, and pressure may damage the product, voiding the warranty.
5. Improper wire selection and installation could overheat wires, and cause fire.
6. Do not connect directly to high voltage or AC power.
7. Installation must be in accordance with local and national electrical code regulations.
8. To ensure safety and correct installation, our strips are intended to be installed by a qualified, licensed electrician.