

Single-wire Triac Dimmer (Zigbee 3.0 + 2.4G)

Model No.: TRI-K2ZR

Features

- Zigbee 3.0 standard protocol
- Built-in temperature detection switch, overload protection, and post-cut phase dimming technology
- Supports minimum brightness setting
- 0~100% stepless dimming, no flicker
- Automatic forwarding: Automatically forward the remote control signal to another lamp, making the remote control distance infinite
- Support "Tuya Smart" APP control (Zigbee 3.0 gateway is needed)
- Supports Alexa, Google Assistant, Yandex Alice, Tmall Genie, Baidu Xiaodu, Xiaomi Xiaoai (Zigbee 3.0 gateway is needed)



Parameters

Name:	Single-wire Triac Dimmer	IP Rating:	IP20
Model No.:	TRI-K2ZR	Working Temperature:	-10~40°C
Input Voltage:	200-240V~ 50/60Hz	EMC Standard (EMC):	ETS IEN 301 489-1 V2.2.3 ETS IEN 301 489-17 V3.2.4
Output:	200-240V~		
Output Current:	Max 1.36A	Safety Standard (LVD):	EN 62368-1:2020+A11:2020
Output Power:	300W @220V		
Protocol:	2.4GHz RF	Radio Equipment (RED):	ETSI EN 300 440 V2.2.1
Control Distance:	Zigbee(Open Area): 50M/ RF: 30M	Certification:	CE, EMC

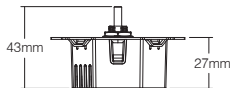
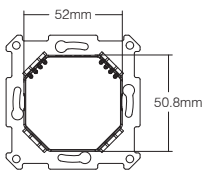
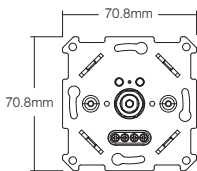

Connection Diagram

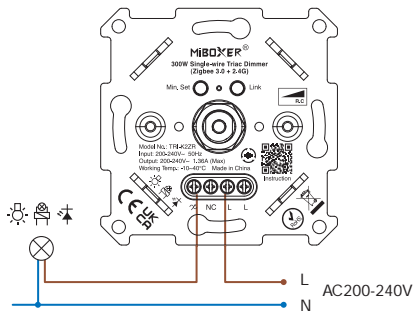

Note: This product is not suitable for direct use with high-voltage LED strips.

Remote Link

Triac dimmer can be connected with remote control

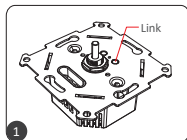

Short press "Link" button 1 time for remote linking.

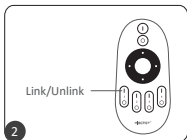

short press " | " 3 times within 3 seconds

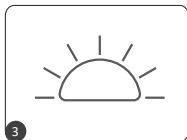

link is done once light flashes 3 times slowly



Link is failed if light doesn't flash, please repeat above steps
(Attention: can not link again if remote already finished linking)

Remote Unlinking

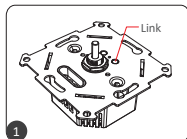

Long press "Link" button 3 seconds for remote Unlinking.



Lights blink 10 times quickly means unlinking is done successfully.



Unlinking failed if light is not blinking quickly, Please follow above steps again.
(Attention: Light haven't linked that don't need to unlink)

Functional Description

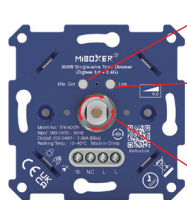

- Short press "Min. SET" to get 10 kinds of brightness: 3%, 5%, 7%, 9%, 12%, 17%, 22%, 28%, 34%, 40%
- Short press "Link" button 1 time for remote linking.
- Long press "Link" button 3 seconds for Zigbee pairing while indicator flashes quickly.
- Rotate the knob to adjust brightness
- Short press the knob to turn the light on and off

Auto transmitting (2.4G RF remote signal)

The controller can transmit remote signal to another controller automatically while the distance between lights are 30m, the remote control distance is unlimited.
(Attention: all controllers must be linked with same remote)

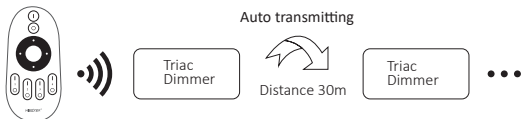

Compatible with these 2.4G RF remote controls (Purchased separately)

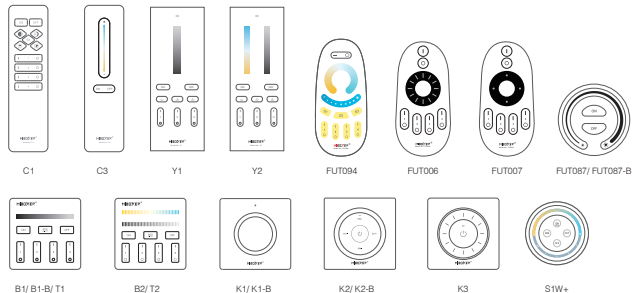

Tuya Smart APP control instruction

Added MiBoxer Zigbee 3.0 gateway into "TUYA Smart" App (please review instruction of Zigbee 3.0 gateway)

Pairing Network

- 1). Connect with power supply
- 2). Pairing network (**attention: factory default is pairing network**)
Long press "LINK" about 3 seconds until indicator flashes quickly
- 3). Open " TUYA Smart " APP to click Zigbee gateway, then click " Add sub device "
- 4). Click " Indicator is flashing quickly "
- 5). Support APP dimming or group control and etc once added successfully

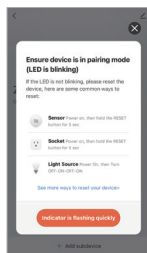
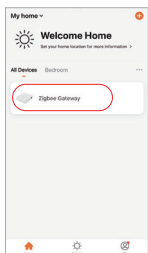
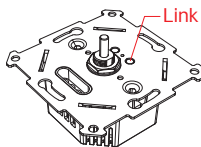

Philips Hue control instruction

Added "Philips Hue" into APP

Pairing Network

- 1). Connect with power supply
- 2). Pairing network (**attention: factory default is pairing network**)
Long press "SET" about 3 seconds until indicator flashes quickly
- 3). Open "Philips Hue" App to click "SETTINGS" and click "Lights"
- 4). Click "+" on the top of right corner
- 5). Click "Search"
- 6). Click "Start configuration", Follow the app instruction to complete configuration

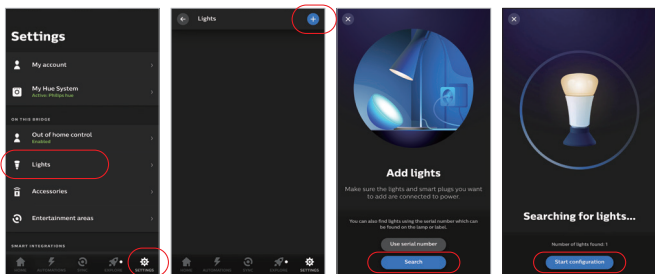

Alexa voice control instruction

Alexa control (Audio support Zigbee 3.0 protocol)

You can connect directly if your Amazon ECHO already is built-in zigbee 3.0 protocol, following model with zigbee 3.0 protocol:

Amazon ECHO Plus (2nd Gen), ECHO (4th Gen), ECHO Studio, ECHO Show (2. Gen)

Pairing Network

- 1). Connect with power supply
- 2). Pairing network (**attention: factory default is pairing network**)
Long press "SET" about 3 seconds until indicator flashes quickly

Say to Amazon ECHO

"Alexa, Discover devices"

Wait for a while to discover device,

Voice control is activated

"Alexa, Discover devices"



Alexa control (Audio don't support Zigbee 3.0 protocol)

Please add device into Miboxer Zigbee 3.0 gateway if your Alexa don't support zigbee 3.0 protocol (check details in page 10), then start following steps

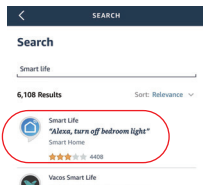
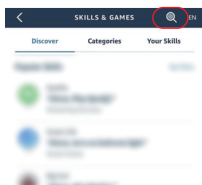
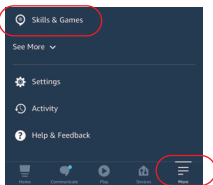

- 1). Open Alexa App
- 2). Click "More" on the bottom of right corner
- 3). Click "Skills & Games"
- 4). Click "Q" on the top of right corner
- 5). Type into "Smart life" and search
- 6). Click "Smart life" skill, follow instruction to finish configuration and start voice control

Google Home voice control instruction

Please add device into MiBoxer Zigbee 3.0 gateway (check details in page 10) and start following steps

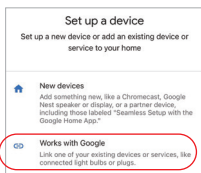
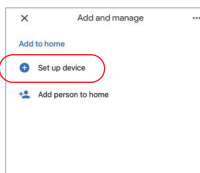
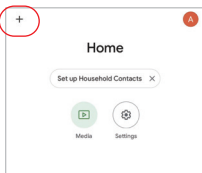

- 1). Open Google Home App
- 2). Click "+" on the top of left corner
- 3). Click "Set up device"
- 4). Click "Works with Google"

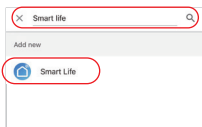

- 5). Click "Q" on the top of right corner
- 6). Type into "Smart life" and search
- 7). Click "Smart life" skill, follow instruction to finish configuration and start voice control

Attention

1. Please turn off power supply before installation.
2. Please ensure input voltage to be same as requirements from device.
3. Don't disassemble device if you are not expert, otherwise it will damage it.
4. Please do not use the light in the place with widely range metal area or strong electromagnetic wave nearby, otherwise, the remote distance will be seriously affected.



Made in China